

[What's in the Box](#)

[Overview](#)

[Using the Battery Connection Cable](#)

[Recharging Your Expansion Battery](#)

[Powering Your Devices](#)

[Storage and Maintenance](#)

[Specifications](#)

Anker SOLIX BP1000/BP1000X Expansion Battery USER GUIDE

What's in the Box



Anker SOLIX BP1000/BP1000X
Expansion Battery*

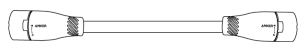

Battery Connection Cable



Important Information

*The expansion battery can not be used alone. It must be connected to the power station for charging and discharging.

Overview

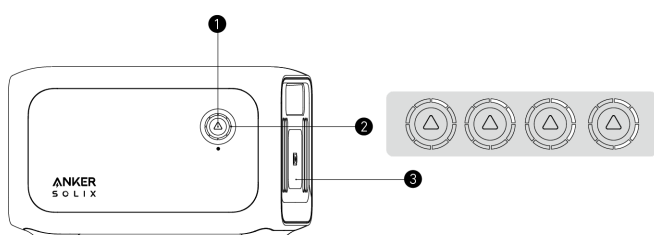

1 Power Button

- Press for 3 seconds to turn on / off when the expansion battery is disconnected from the power station.
- Press for 2 seconds to stop or restart the connection between the expansion battery and power station.

2 LED Light-Wheel

- Flashes white in sequence when recharging.
- Indicates the remaining battery level with a 1-second press of the power button.

The light will automatically turn off after 30 seconds.

3 Expansion Battery Port

- Connect the expansion battery to the power station via this port.

Using the Battery Connection Cable

The battery connection cable is used for connecting the expansion battery and the power station.

- To connect, insert the cable directly with the Anker logo in the top center. You will hear a click when the cable is locked.
- To disconnect, push the knob and turn it 12.5 degrees counterclockwise before pulling it out.

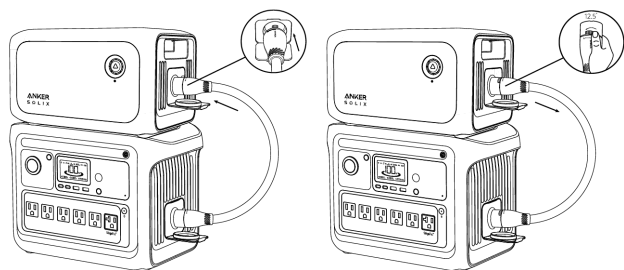

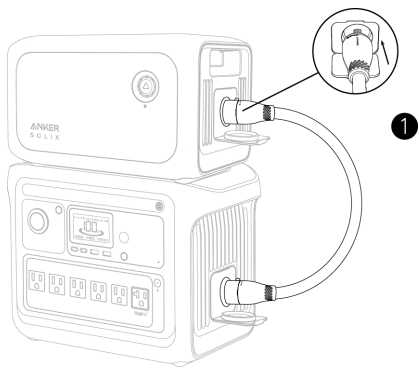

Recharging Your Expansion Battery

1. Plug the battery connection cable into the expansion battery and the power station.

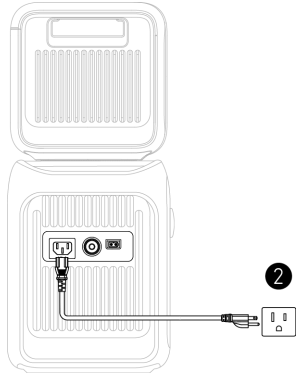

2. Recharge the power station via AC input or DC input.



- The plug varies by region.
- When the expansion battery is connected successfully, you will hear a beep and  will appear on the power station's screen.
- The expansion battery will be charged after the power station is fully charged.

Powering Your Devices

1. Connect the expansion battery to the power station using the included battery connection cable.

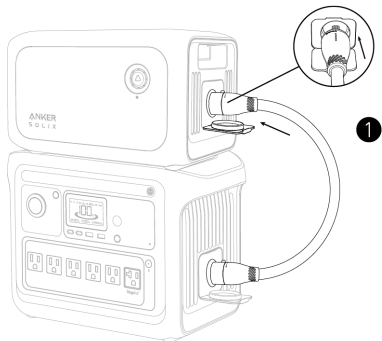

2. Press the main power button on the power station for three seconds to turn it on.

3. Connect your devices to the power station using the AC ports, USB ports, or car socket. If needed, turn on the AC outlet button or car socket button.

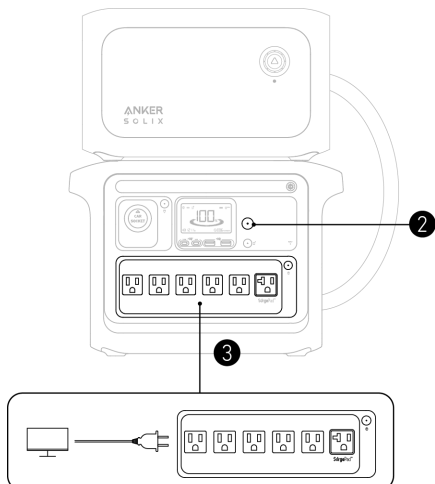

- The plugs vary by region.
- The expansion battery icon will appear on the power station's screen when it is successfully connected. If not, you will have to reconnect both devices as there may be a poor connection.
- The expansion battery will charge your devices first until its battery runs out. The power station will then continue charging your devices automatically.
- If you need to cut off or restart the connection between the expansion battery and power station when they are in use, press the expansion battery's power button for 2 seconds to avoid a short circuit.

Storage and Maintenance

If the expansion battery is stored at a low capacity for a long time, lithium batteries will self-consume power which may lead to a quick discharge. This often leads to poor conductivity and a reduced battery lifespan that causes the battery not to work.

When storing your expansion battery, make sure that you:

1. Turn off all the outputs.
2. Keep the expansion battery in a dry and cool environment.
3. Check the remaining battery capacity each week. If the battery level is below 30% (only two indicators are on), please charge the expansion battery to full. Remember to charge it to 100% once every 3 months.

Specifications

Specifications are subject to change without notice.

Capacity	1056Wh
Expansion Battery Port Input	36A
Expansion Battery Port Output	65A
Discharging Temperature	-4°F - 104°F / -20°C - 40°C
Charging Temperature	32°F - 104°F / 0°C - 40°C
Size	12.72×0.64×7.83 in / 32.3×19.5×19.9 cm
Net Weight	9.06 kg / 19.97 lb